

Single phase capacitors: 250 V, 50 Hz, Box/Square Type

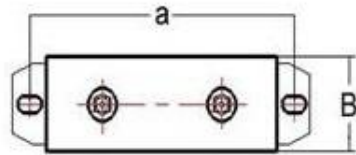
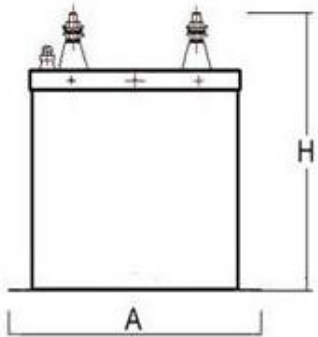

Pattern B

| Type | Rated Voltage | Rated Capacitance | Static Capacity | Rated Current (A) | Dimension A*B*H/a (mm) | Terminal type |
|---------------|---------------|-------------------|-----------------|-------------------|------------------------|---------------|
| | (V) | (KVAR) | (uF) | | | |
| BKMJ0.25-5-1 | 250 | 5 | 255 | 20.0 | 272*74*320/247 | B |
| BKMJ0.25-10-1 | 250 | 10 | 510 | 40.0 | 272*74*320/247 | B |
| BKMJ0.25-15-1 | 250 | 15 | 764 | 60.0 | 345*112*310/315 | B |

Technical data:

Temperature category: -25°C-50°C

Discharge resistors: 75 V/ 3 min

Dielectric: MKP - metallized PP film

Design: dry type, non PCB

Standard: IEC 60831

