

Single phase capacitors: 415 V, 50 Hz, Box/Square Type

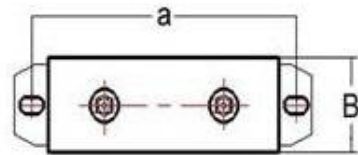
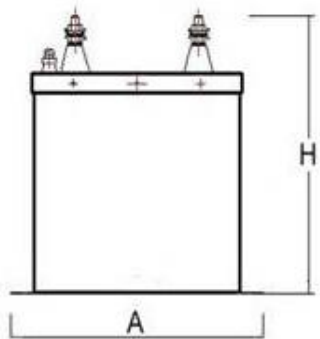

**Pattern B**

Type	Rated Voltage	Rated Capacitance	Static Capacity	Rated Current	Dimension	Terminal type
	(V)	(KVAR)	(uF)	(A)	A*B*H/a (mm)	
BKMJ0.415-15-1	415	15	278	36.1	250*67*285/225	B
BKMJ0.415-25-1	415	25	462	60.2	234*128*300/219	B
BKMJ0.415-30-1	415	30	555	72.3	345*112*310/315	B
BKMJ0.415-40-1	415	40	739	96.4	386*128*310/358	B
BKMJ0.415-50-1	415	50	925	120.5	441*130*310/413	B
BKMJ0.415-75-1	415	75	1387	180.7	441*175*330/413	B
BKMJ0.415-100-1	415	100	1849	241.0	441*193*330/413	B

**Technical data:**

**Temperature category:** -25°C-50°C

**Discharge resistors:** 75 V/ 3 min

**Dielectric:** MKP - metallized PP film

**Design:** dry type, non PCB

**Tandard:** IEC 60831

